

## *Industry Exclusive Features* available on the **Heavy Products Sampling System**



The SENSOR Heavy Products Sample System (HPSS) is designed to collect samples of hot, heavy products (such as resid, asphalt, hot tar, gas oil, resins, slurries, surfactants and emulsions) while maintaining personnel safety.

The High Viscosity “HV” Sample Valve has increased port size over the typical BBSS valve to handle heavier products while allowing the operator to control the rate of flow into the container.

### **Sample Heavy Products with Minimal Downtime**

The HPSS comes with 3 standard features unique to SENSOR which include a removable cartridge valve, condensate-free steam flush assembly and twist lock purge adapter.

#### **1 Removable Cartridge Valve.**

Allows for separating the valve's critical components from the sample line without removing the valve body and pipe spool from the process line in the event of required maintenance. The cartridge can simply be removed from the sample valve base and repaired or replaced with a new one, greatly reducing downtime.

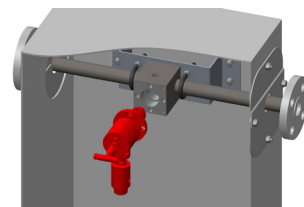

#### **2 Condensate-free Steam Flush Assembly.**

This assembly utilizes a unique 3-way valve and steam trap to ensure that condensate-free steam is consistently available for purge operations. The steam purge clears any potential blockage from the sample path without disrupting the process flowing in the sample line.



#### **3 Twist Lock Purge Adapter.**

Without the need for tools, an operator can easily install the twist lock purge adapter onto the dispense tube and utilize steam to completely flush out the sample pathway to the drain of the enclosure. The steam flush is directed in a controlled manner without creating a mess on the inside of the enclosure or window from splatter.

**SENSOR**  
SAMPLING SYSTEMS